

DEKOR

due: 17 17 2014

PROVED LA

Usap.

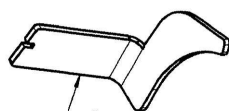

11914 012807-Symetrical

cytometry

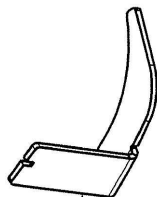

11914012804-

According to plan

DE PLAXI

Detail E
2:1

- 2 - 03 - 2015

ARCHIV

№ 14/01402

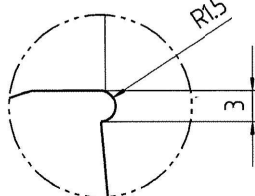

NOTA: ΠΟΥΣΤΗΚΑ ΝΑΙ.

- Metal sheet thickness : 6 mm
- Radii without dimension : $R = 4$
- Bond radii : $R = 10$

VENST. 12#30052
RADWS 077730

LASER cutting tolerances					
NOTA : min cutting widths without dimensions ± 1 mm unless otherwise specified					
≤ 30	$30 < \leq 120$	$120 < \leq 400$	$400 < \leq 1000$	$1000 <$	
± 0.5	± 0.8	± 1.0	± 1.5	± 2.0	

[illegible]

Condition at time of delivery	X
de-scaled (degree of purity SA 2 1/2 acc. ISO 8501-1)	
without burrs acc. WN 1130	
Permissible top-end rounding during flame cutting (also positive bead acc. WN 10572)	
oil-free / free of grease	
oiled	
oiling permissible	X
Indicate the required condition at time of delivery with an X.	